

# CITY OF LANGLEY ZONING BYLAW, 1996, NO. 2100 SCHEDULE "A"

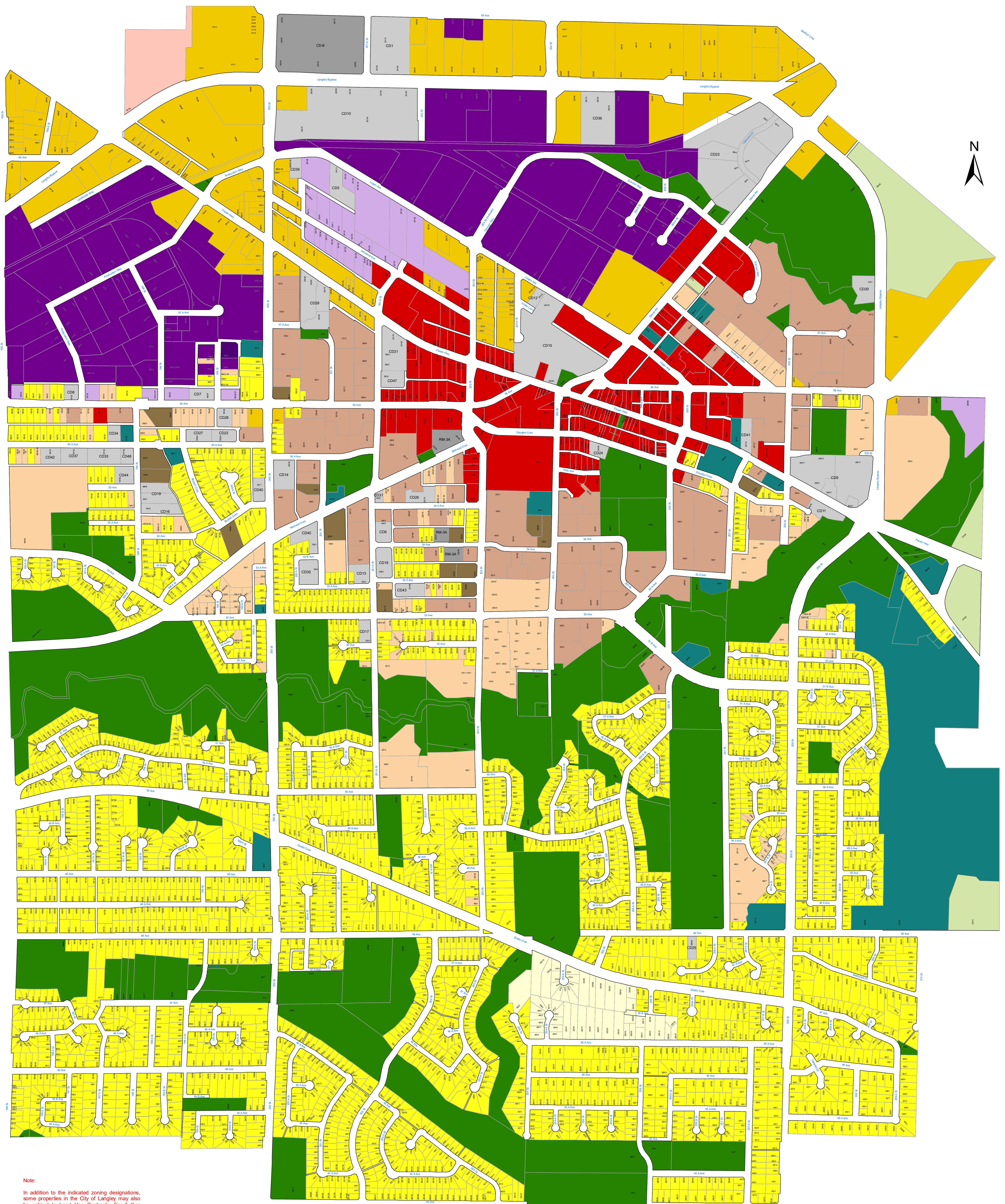

**Note:**  
In addition to the indicated zoning designations, some properties in the City of Langley may also be subject to Land Use Contracts. For further information on Land Use Contracts, please consult with Development Services Department staff.

### Legend

- |   |  |
|---|--|
| <ul style="list-style-type: none"> <li><span style="display: inline-block; width: 15px; height: 10px; background-color: yellow; border: 1px solid black; margin-right: 5px;"></span> RS1 Single Family Residential Zone</li> <li><span style="display: inline-block; width: 15px; height: 10px; background-color: #ffffcc; border: 1px solid black; margin-right: 5px;"></span> RS2 Estate Residential Zone</li> <li><span style="display: inline-block; width: 15px; height: 10px; background-color: #fff2cc; border: 1px solid black; margin-right: 5px;"></span> RM1 Multiple Residential Low Density Zone</li> <li><span style="display: inline-block; width: 15px; height: 10px; background-color: #fce4d6; border: 1px solid black; margin-right: 5px;"></span> RM2 Multiple Residential Medium Density Zone</li> <li><span style="display: inline-block; width: 15px; height: 10px; background-color: #f4cccc; border: 1px solid black; margin-right: 5px;"></span> RM3 Multiple Residential High Density Zone</li> <li><span style="display: inline-block; width: 15px; height: 10px; background-color: #f4cccc; border: 1px solid black; margin-right: 5px;"></span> C1 Downtown Commercial Zone</li> <li><span style="display: inline-block; width: 15px; height: 10px; background-color: #fff2cc; border: 1px solid black; margin-right: 5px;"></span> C2 Service Commercial Zone</li> <li><span style="display: inline-block; width: 15px; height: 10px; background-color: #f4cccc; border: 1px solid black; margin-right: 5px;"></span> C3 Specific Commercial Zone</li> </ul> | <ul style="list-style-type: none"> <li><span style="display: inline-block; width: 15px; height: 10px; background-color: #90ee90; border: 1px solid black; margin-right: 5px;"></span> P1 Public Institutional/Recreation Zone</li> <li><span style="display: inline-block; width: 15px; height: 10px; background-color: #90ee90; border: 1px solid black; margin-right: 5px;"></span> P2 Private Institutional/Recreation Zone</li> <li><span style="display: inline-block; width: 15px; height: 10px; background-color: #90ee90; border: 1px solid black; margin-right: 5px;"></span> I1 Light Industrial Zone</li> <li><span style="display: inline-block; width: 15px; height: 10px; background-color: #90ee90; border: 1px solid black; margin-right: 5px;"></span> I2 Service Industrial Zone</li> <li><span style="display: inline-block; width: 15px; height: 10px; background-color: #90ee90; border: 1px solid black; margin-right: 5px;"></span> I3 Special Industrial Zone</li> <li><span style="display: inline-block; width: 15px; height: 10px; background-color: #90ee90; border: 1px solid black; margin-right: 5px;"></span> A1 Agricultural Zone</li> <li><span style="display: inline-block; width: 15px; height: 10px; background-color: #90ee90; border: 1px solid black; margin-right: 5px;"></span> CD Comprehensive Development Zone</li> <li><span style="display: inline-block; width: 15px; height: 10px; background-color: #90ee90; border: 1px solid black; margin-right: 5px;"></span> Bylaw 950 Zone</li> </ul> |
|---|--|

1:4,000

Prepared by:  
Development Services Department  
Date of Last Revision: December 4, 2017

