

CITY OF LANGLEY ZONING BYLAW, 1996, NO. 2100 SCHEDULE "A"

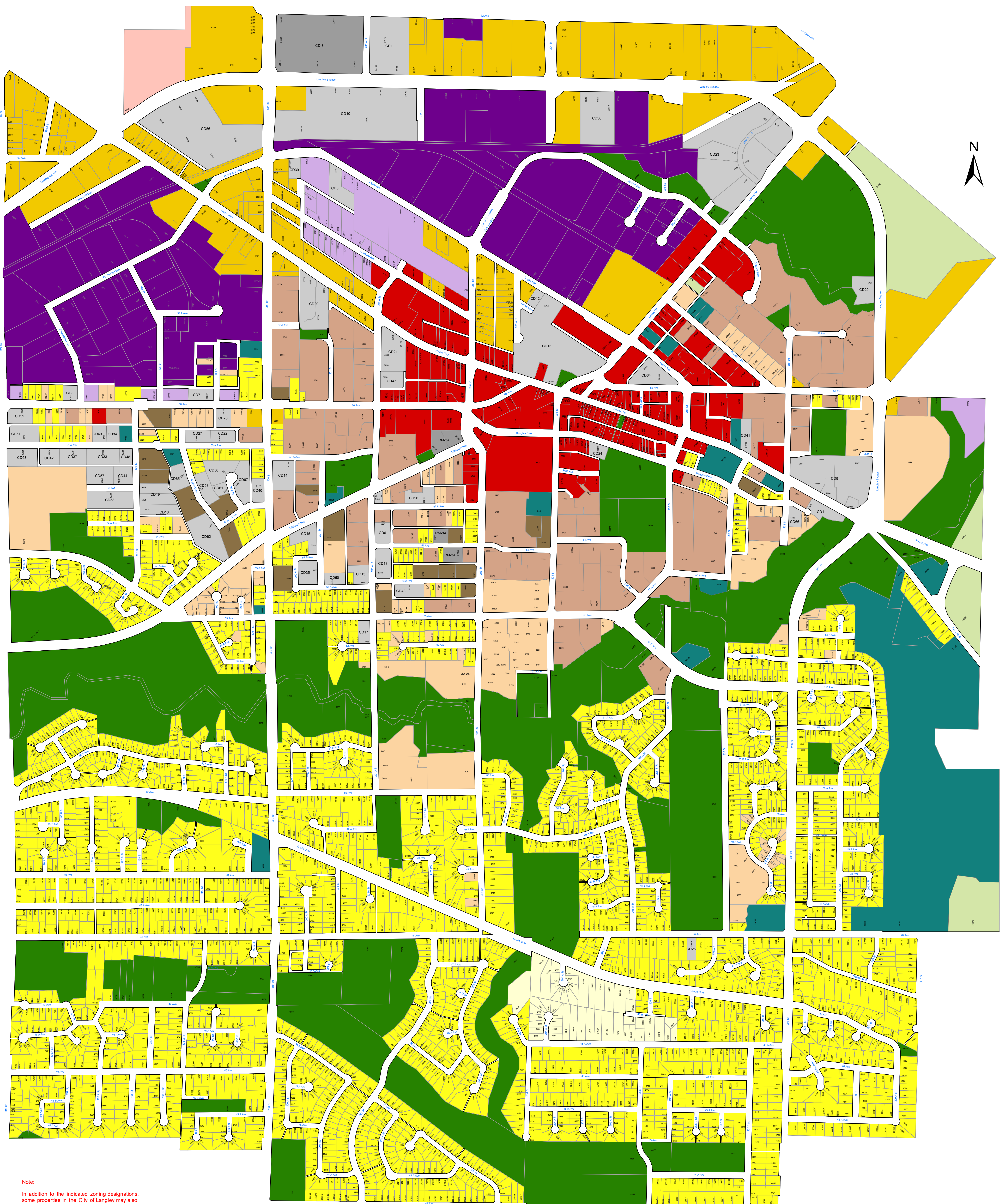

Note:
In addition to the indicated zoning designations, some properties in the City of Langley may also be subject to Land Use Contracts. For further information on Land Use Contracts, please consult with Development Services Department staff.

Legend

- | | | | |
|----------------------------------------------|--------------------------------------------|------------------------------------------|-----------------------------------|
| RS1 Single Family Residential Zone | RM3 Multiple Residential High Density Zone | P1 Public Institutional/Recreation Zone | I3 Special Industrial Zone |
| RS2 Estate Residential Zone | C1 Downtown Commercial Zone | P2 Private Institutional/Recreation Zone | A1 Agricultural Zone |
| RM1 Multiple Residential Low Density Zone | C2 Service Commercial Zone | I1 Light Industrial Zone | CD Comprehensive Development Zone |
| RM2 Multiple Residential Medium Density Zone | C3 Specific Commercial Zone | I2 Service Industrial Zone | Bylaw 950 Zone |

1:4,000

Prepared by:
Development Services Department
Date of Last Revision: July 28, 2020

