

SCALE:

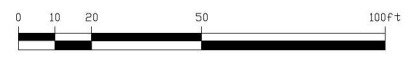

FENCE LEGEND	
KEY	DESCRIPTION
	3'4" HEIGHT WOOD PICKET FENCE
	4' HEIGHT WOOD SIDERYARD FENCE
	6' HEIGHT WOOD PRIVACY FENCE

PLANT SCHEDULE				PMG PROJECT NUMBER: 23-164
KEY	QTY	BOTANICAL NAME	COMMON NAME	PLANTED SIZE / REMARKS
TREE				
	4	CORNUS FLORIDA 'RUBRA'	PINK FLOWERING DOGWOOD	50M CAL, 1.5M STD, B&B, CLIMATE RESILIENT
	1	CUPRESSUS x LEYLANDII	LEYLANDII CYPRESS	2.5M HT, B&B, CLIMATE RESILIENT
	2	MAGNOLIA GRANDIFLORA 'TEDDY BEAR'	TEDDY BEAR SOUTHERN MAGNOLIA	5 CM CAL, 1.5M STD, B&B, CLIMATE RESILIENT
	6	STYRAX JAPONICUS 'SNOWCONE'	SNOWCONE JAPANESE SNOWBELL	5.0CM CAL, 1.5M STD, B&B, CLIMATE RESILIENT
	2	ZELKOVA SERRATA 'GREEN VASE'	GREEN VASE ZELKOVA	60M CAL, 1.5M STD, B&B, CLIMATE RESILIENT
SHRUB				
	322	BUXUS SEMPERVIRENS	COMMON BOXWOOD	#2 POT, 25CM, DROUGHT TOLERANT
	30	PIERIS JAPONICA 'DAVATINE'	PIERIS - DWARF	#2 POT, 30CM
	40	RHOODENDRON ROBILEZA PPWF	AUTUMN BONFIRE AZALEA, RED-EVERGREENING	#2 POT, 25CM
	75	SARCOCOCCA HOOKERIANA VAR. HUMILIS	HIMALAYAN SWEET BOX	#2 POT, 25CM
	12	SKIMMIA REVESSIANA	DIWANE SKIMMIA	#2 POT, 25CM
	56	TAXUS X MEDIA 'HILLSIDE'	HILL'S YEW	1.5M HT, B&B, NO BERRIES
GRASS				
	10	CALAMAGROSTIS ACUTIFLORA 'KARL FOERSTER'	FEATHER REED GRASS	#1 POT
	169	CAREX OSHIMENSIS 'EVERGOLD'	EVERGOLD JAPANESE SEDGE	#1 POT
	143	HELICTOTRICHON SEMPERVIRENS	BLUE OAT GRASS	#1 POT
PERENNIAL				
	39	ACHILLEA 'PAPRIKA'	RED YARROW	15CM POT
	31	ECHINACEA PURPUREA 'SOMBRERO SALSA'	RED CONEFLOWER	15CM POT
	63	HELLEBORUS x HYBRIDUS	LENTEN ROSE	15CM POT
	21	HOSTA 'BLUE MAMMOTH'	HOSTA 'LARGE BLUE'	#2 POT, 1.2-EYE
	49	SEDUM CAUTICOLA 'BETRAM ANDERSON'	BETRAM ANDERSON STONECROP	5CM POT
	24	POLYSTICHUM MUNIUM	WESTERN SWORD FERN	#1 POT, 20CM

NOTES: * PLANT SIZES IN THIS LIST ARE SPECIFIED ACCORDING TO THE BC LANDSCAPE STANDARD AND CANADIAN LANDSCAPE STANDARD, LATEST EDITION. CONTAINER SIZES SPECIFIED AS PER CNLA STANDARDS. BOTH PLANT SIZE AND CONTAINER SIZE ARE THE MINIMUM ACCEPTABLE SIZES. * REFERS TO SPECIFICATIONS FOR DEFINED CONTAINER MEASUREMENTS AND OTHER PLANT MATERIAL REQUIREMENTS. * SEARCH AND REVIEW: MAKE PLANT MATERIAL AVAILABLE FOR OPTIONAL REVIEW BY LANDSCAPE ARCHITECT AT SOURCE OF SUPPLY. AREA OF SEARCH TO INCLUDE LOWER MAINLAND AND FRASER VALLEY. * SUBSTITUTIONS: OBTAIN WRITTEN APPROVAL FROM THE LANDSCAPE ARCHITECT PRIOR TO MAKING ANY SUBSTITUTIONS. TO THE SPECIFIED MATERIAL. UNAPPROVED SUBSTITUTIONS WILL BE REJECTED. ALLOW A MINIMUM OF FIVE DAYS PRIOR TO DELIVERY FOR REQUEST TO SUBSTITUTE. SUBSTITUTIONS ARE SUBJECT TO BC LANDSCAPE STANDARD AND CANADIAN LANDSCAPE STANDARD - DEFINITION OF CONDITIONS OF AVAILABILITY. * ALL LANDSCAPE MATERIAL AND WORKSMANSHIP MUST MEET OR EXCEED BC LANDSCAPE STANDARD AND CANADIAN LANDSCAPE STANDARD LATEST EDITION. * ALL PLANT MATERIAL MUST BE PROVIDED FROM CERTIFIED DISEASE FREE NURSERY. * BIO-SOLIDS NOT PERMITTED IN GROWING MEDIUM UNLESS AUTHORIZED BY LANDSCAPE ARCHITECT.

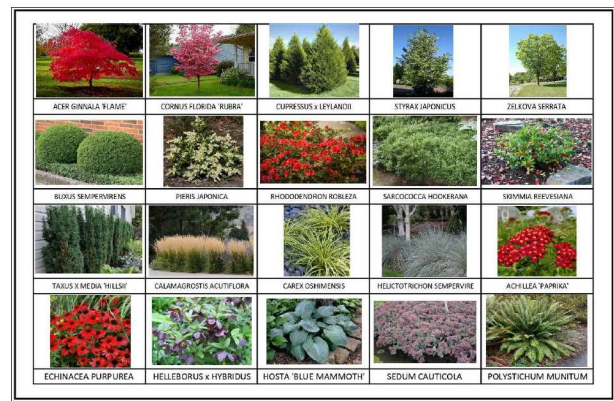

NO. DATE REVISION DESCRIPTION DR.

CLIENT:

PROJECT:
RESIDENTIAL PROJECT
5030, 5040, 5052 & 5064 208TH AVE
CITY OF LANGLEY

DRAWING TITLE:
LANDSCAPE PLAN

DATE: 23 OCT 19 DRAWING NUMBER:
SCALE: 1/16" = 1'-0"
DRAWN: CLG
DESIGN: CLG
CHKD: CW

L1
OF 4

